



TRANSPORTATION CABINET

Frankfort, Kentucky 40622
www.transportation.ky.gov/

Steven L. Beshear
Governor

Michael W. Hancock, P.E.
Secretary

June 11, 2012

CALL NO. 305
CONTRACT ID NO. 121328
ADDENDUM # 1

Subject: Hardin County, FD04 SSP 047 0251 001-003
Letting June 15, 2012

- (1) Revised - Plan Sheets - R2n, R2p & R179
- (2) Revised - Bid Items - Pages 61-67 of 67

Proposal revisions are available at <http://transportation.ky.gov/Construction-Procurement/>.

Plan revisions are available at <http://www.lynnimaging.com/kytransportation/>.

If you have any questions, please contact us at 502-564-3500.

Sincerely,

A handwritten signature in blue ink that reads "Ryan Griffith".

Ryan Griffith
Director
Division of Construction Procurement

RG:ks
Enclosures



An Equal Opportunity Employer M/F/D

DESIGN PH LEVEL	MAX. COVER HEIGHT (FT)	CBI TYPE A (EACH)	DBI TYPE 3 (EACH)	STORM SEWER PIPE 15 IN. (FT)	STORM SEWER PIPE 18 IN. (FT)	STORM SEWER PIPE 30 IN. (FT)	STORM SEWER PIPE 42 IN. EQUIV. ELLIP. (FT)	STEEL REIN. (LB)	CONC. CLASS A (CU. YD.)	*STEEL ENCASEMENT PIPE - 30" (FT)	BORE AND JACK PIPE (FT)
-----------------	------------------------	-------------------	-------------------	------------------------------	------------------------------	------------------------------	--	------------------	-------------------------	-----------------------------------	-------------------------

FLOOD EVALUATION DATA			
	R.I.	Q (cfs)	H.W. (ft)
DESIGN	10	4.3	838.48
CHECK	100	6.1	838.60

Sta. 201+15 Lt. 71.4 ft
Const. DBI Type 3
H= 4.50 ft
F.L. = 838.05
I.E. = 833.55

Sta. 201+11 Lt. 53.4 ft
Const. CBI Type A-28-6 (Sag)
H= 6.25 ft
F.L. = 838.10
I.E. = 831.85

Sta. 200+85 Rt. to Sta. 201+89 Rt.
Const. 104 ft of 18" Pipe

Sta. 200+85 Rt. 53.7 ft
Const. CBI Type A-28-2
H= 6.25 ft
F.L. = 836.24
I.E. = 829.49

*The unit price bid for STEEL ENCASEMENT PIPE - 30" shall be for an encasement pipe of sufficient size to allow for installation of a 30" Storm Sewer Pipe.

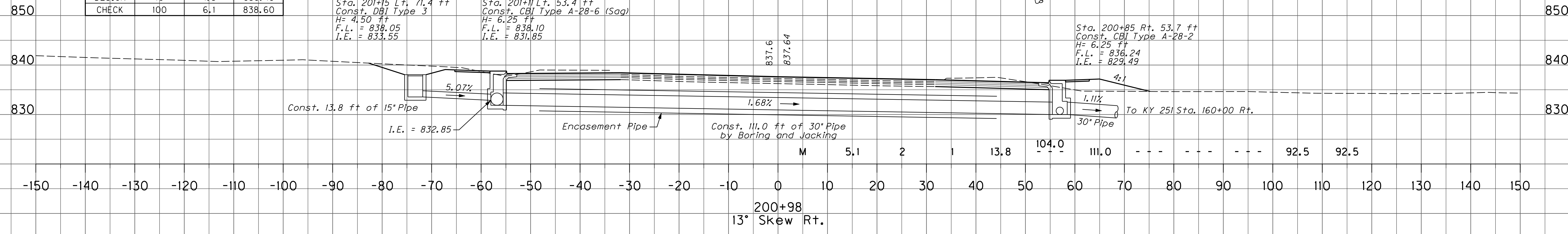

FLOOD EVALUATION DATA			
	R.I.	Q (cfs)	H.W. (ft)
DESIGN	10	1.1	837.42
CHECK	100	1.4	837.45

Sta. 199+50 Lt. 64.0 ft
Const. DBI Type 3 (No Apron)
H= 3.00 ft
F.L. = 837.25
I.E. = 834.25

Sta. 199+50 Lt. to KY 251 Sta. 162+21 Lt.
Const. 62 ft of 18" Pipe

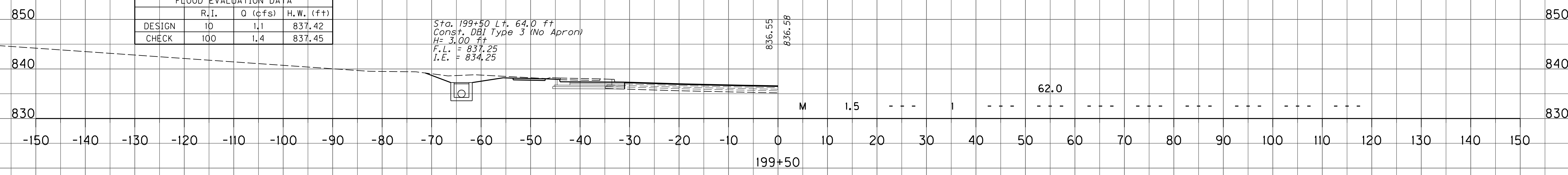

Sta. 198+22 Lt. to Sta. 199+50 Lt.
Const. 128 ft of 18" Pipe

Sta. 199+00 Rt. to KY 251 Sta. 160+00 Lt.
Const. 60 ft of 42" Equiv. Ellip. Pipe

Sta. 199+00 Rt. 60.7 ft
Const. CBI Type A-47-2
H= 6.00 ft
F.L. = 834.27
I.E. = 828.27

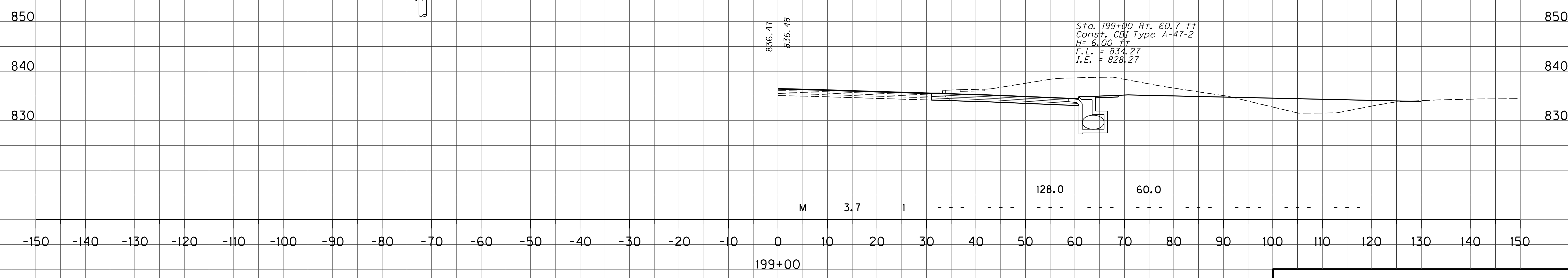

BURGESS & NIPE

PREPARED BY _____ DATE _____
 CHECKED BY _____ DATE _____
 APPROVED BY _____ DATE _____

VENDORS NAME
 1-92
 FORM NO. 6
 Cell Library: kyt.cel
 Cell Name: sxs
 6/6/2012 5:04:56 PM
 p:\x049301\plans\17500pct.dgn

**RING ROAD PIPE SECTIONS
STA. 199+00 TO STA. 200+98**

DESIGN PH LEVEL	MAX. COVER HEIGHT (FT)	CBI TYPE A (EACH)	DBI TYPE 3 (EACH)	STORM SEWER PIPE 15 IN. (FT)	STORM SEWER PIPE 18 IN. (FT)	STORM SEWER PIPE 30 IN. (FT)	STORM SEWER PIPE 42 IN. EQUIV. ELLIP. (FT)	STEEL REIN. (LB)	CONC. CLASS A (CU. YD.)	*STEEL ENCASEMENT PIPE - 30" (FT)	BORE AND JACK PIPE (FT)	COUNTY OF	ITEM NO.	SHEET NO.
												HARDIN	4-7030.00	R179

FLOOD EVALUATION DATA			
	R.I.	Q (cfs)	H.W. (ft)
DESIGN	10	4.3	838.48
CHECK	100	6.1	838.60

Sta. 201+15 Lt. 71.4 ft
Const. DBI Type 3
H= 4.50 ft
F.L. = 838.05
I.E. = 833.55

Sta. 201+11 Lt. 53.4 ft
Const. CBI Type A-28-6 (Sag)
H= 6.25 ft
F.L. = 838.10
I.E. = 831.85

Sta. 200+85 Rt. to Sta. 201+89 Rt.
Const. 104 ft of 18" Pipe

Sta. 200+85 Rt. 53.7 ft
Const. CBI Type A-28-2
H= 6.25 ft
F.L. = 836.24
I.E. = 829.49

*The unit price bid for STEEL ENCASEMENT PIPE - 30" shall be for an encasement pipe of sufficient size to allow for installation of a 30" Storm Sewer Pipe.

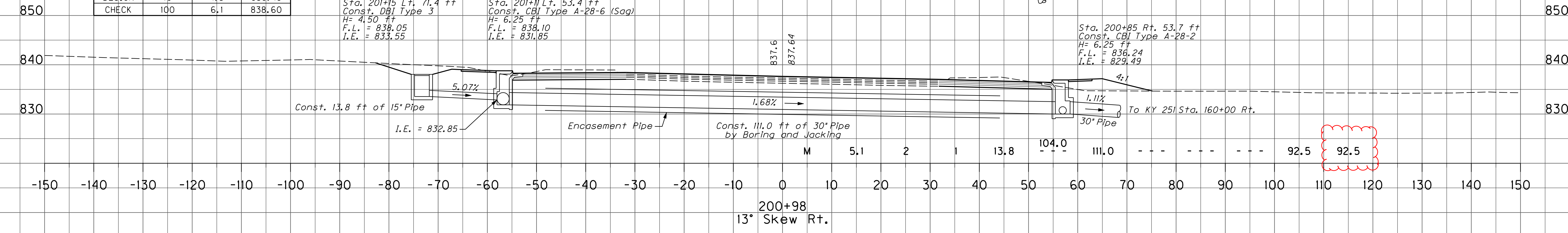

FLOOD EVALUATION DATA			
	R.I.	Q (cfs)	H.W. (ft)
DESIGN	10	1.1	837.42
CHECK	100	1.4	837.45

Sta. 199+50 Lt. 64.0 ft
Const. DBI Type 3 (No Apron)
H= 3.00 ft
F.L. = 837.25
I.E. = 834.25

Sta. 199+50 Lt. to KY 251 Sta. 162+21 Lt.
Const. 62 ft of 18" Pipe

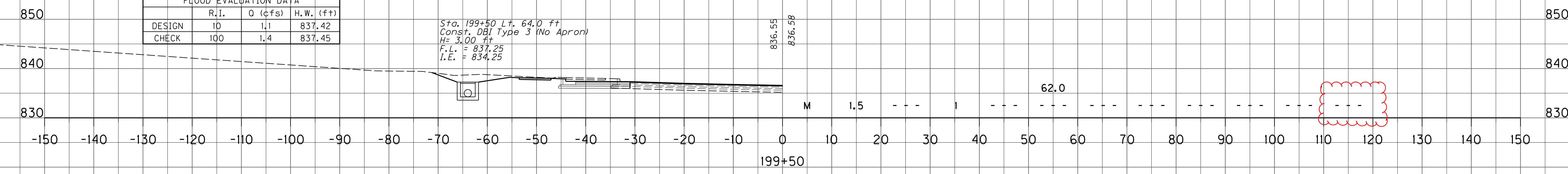

Sta. 198+22 Lt. to Sta. 199+50 Lt.
Const. 128 ft of 18" Pipe

Sta. 199+00 Rt. to KY 251 Sta. 160+00 Lt.
Const. 60 ft of 42" Equiv. Ellip. Pipe

Sta. 199+00 Rt. 60.7 ft
Const. CBI Type A-47-2
H= 6.00 ft
F.L. = 834.27
I.E. = 828.27

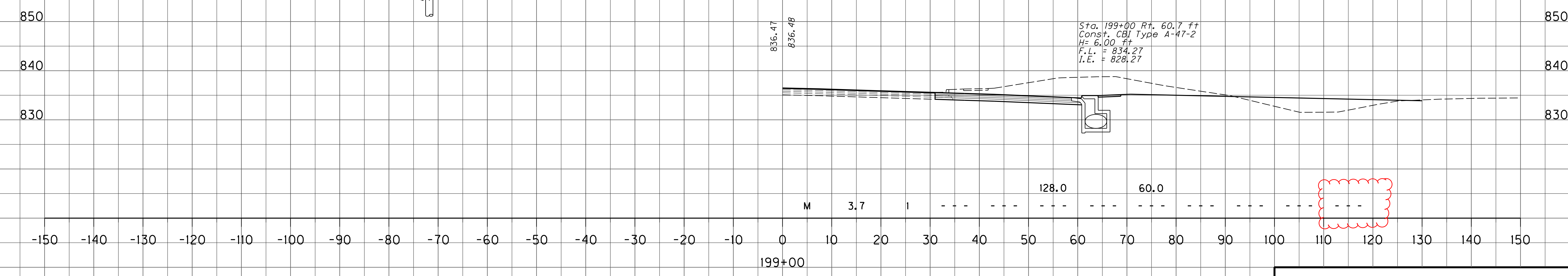

BURGESS & NIPL

PREPARED BY _____ DATE _____
CHECKED BY _____ DATE _____
APPROVED BY _____ DATE _____

VENDORS NAME
1-92
FORM NO. 6

Cell Library: kytc.cel
Cell Name: sxs
6/6/2012 5:04:56 PM
p:\x049301\plans\17500pct.dgn

RING ROAD PIPE SECTIONS
STA. 199+00 TO STA. 200+98

CONTRACT ID: 121328
COUNTY: HARDIN
PROPOSAL: FD04 SSP 047 0251 001-003

PAGE: 1
LETTING: 06/15/12
CALL NO: 305

LINE NO	ITEM	DESCRIPTION	APPROXIMATE QUANTITY	UNIT	UNIT PRICE	AMOUNT
SECTION 0001 PAVING						
0010	00001	DGA BASE	2,721.000	TON		
0020	00003	CRUSHED STONE BASE	18,672.000	TON		
0030	00020	TRAFFIC BOUND BASE	1,000.000	TON		
0040	00190	LEVELING & WEDGING PG64-22	5,141.000	TON		
0050	00221	CL2 ASPH BASE 0.75D PG64-22	32,272.000	TON		
0060	00307	CL2 ASPH SURF 0.38B PG64-22	5,401.000	TON		
0070	02101	CEM CONC ENT PAVEMENT-8 IN	4,498.000	SQYD		
SECTION 0002 ROADWAY						
0080	00078	CRUSHED AGGREGATE SIZE NO 2	5,144.000	TON		
0090	01314	PLUG PIPE	12.000	EACH		
0100	01717	FILL AND CAP INLET	1.000	EACH		
0110	01786	FILL AND CAP MANHOLE	5.000	EACH		
0120	01810	STANDARD CURB AND GUTTER	16,015.000	LF		
0130	01875	STANDARD HEADER CURB	630.000	LF		
0140	01891	ISLAND HEADER CURB TYPE 2	71.000	LF		
0150	01917	STANDARD BARRIER MEDIAN TYPE 2	56.000	SQYD		
0160	02014	BARRICADE-TYPE III	6.000	EACH		
0170	02091	REMOVE PAVEMENT	1,765.000	SQYD		
0180	02157	PAVED DITCH TYPE 1	503.000	SQYD		
0190	02159	TEMP DITCH	9,354.000	LF		

CONTRACT ID: 121328
COUNTY: HARDIN
PROPOSAL: FD04 SSP 047 0251 001-003

PAGE: 2
LETTING: 06/15/12
CALL NO: 305

LINE NO	ITEM	DESCRIPTION	APPROXIMATE QUANTITY	UNIT	UNIT PRICE	AMOUNT
0200	02200	ROADWAY EXCAVATION	31,411.000	CUYD		
0210	02203	STRUCTURE EXCAV-UNCLASSIFIED	101.000	CUYD		
0220	02242	WATER	2.000	MGAL		
0230	02267	REMOVE & RESET FENCE	373.000	LF		
0240	02429	RIGHT-OF-WAY MONUMENT TYPE 1	116.000	EACH		
0250	02430	RIGHT-OF-WAY MONUMENT TYPE 1A	6.000	EACH		
0260	02432	WITNESS POST	30.000	EACH		
0270	02483	CHANNEL LINING CLASS II	50.000	TON		
0280	02545	CLEARING AND GRUBBING (13 ACRES)	(1.00)	LS		
0290	02551	CONCRETE-CLASS A FOR STEPS	10.000	CUYD		
0300	02555	CONCRETE-CLASS B	68.000	CUYD		
0310	02562	SIGNS	805.000	SQFT		
0320	02585	EDGE KEY	305.000	LF		
0330	02598	FABRIC-GEOTEXTILE TYPE III	10,586.000	SQYD		
0340	02600	FABRIC GEOTEXTILE TY IV FOR PIPE	59,700.000	SQYD	2.00	119,400.00
0350	02619	HANDRAIL-TYPE A	100.000	LF		
0360	02650	MAINTAIN & CONTROL TRAFFIC	(1.00)	LS		
0370	02676	MOBILIZATION FOR MILL & TEXT	(1.00)	LS		
0380	02677	ASPHALT PAVE MILLING & TEXTURING	640.000	TON		
0390	02690	SAFELOADING	116.000	CUYD		
0400	02701	TEMP SILT FENCE	9,354.000	LF		

CONTRACT ID: 121328
COUNTY: HARDIN
PROPOSAL: FD04 SSP 047 0251 001-003

PAGE: 3
LETTING: 06/15/12
CALL NO: 305

LINE NO	ITEM	DESCRIPTION	APPROXIMATE QUANTITY	UNIT	UNIT PRICE	AMOUNT
0410	02704	SILT TRAP TYPE B	154.000	EACH		
0420	02705	SILT TRAP TYPE C	165.000	EACH		
0430	02707	CLEAN SILT TRAP TYPE B	462.000	EACH		
0440	02708	CLEAN SILT TRAP TYPE C	495.000	EACH		
0450	02709	CLEAN TEMP SILT FENCE	28,062.000	LF		
0460	02720	SIDEWALK-4 IN CONCRETE	8,804.000	SQYD		
0470	02726	STAKING	(1.00)	LS		
0480	05950	EROSION CONTROL BLANKET	2,791.000	SQYD		
0490	05952	TEMP MULCH	181,751.000	SQYD		
0500	05953	TEMP SEEDING AND PROTECTION	181,751.000	SQYD		
0510	05966	TOPDRESSING FERTILIZER	2.000	TON		
0520	05985	SEEDING AND PROTECTION	29,593.000	SQYD		
0530	05990	SODDING	17,918.000	SQYD		
0540	06510	PAVE STRIPING-TEMP PAINT-4 IN	37,437.000	LF		
0550	06514	PAVE STRIPING-PERM PAINT-4 IN	39,073.000	LF		
0560	06515	PAVE STRIPING-PERM PAINT-6 IN	2,433.000	LF		
0570	06540	PAVE STRIPING-THERMO-4 IN W	580.000	LF		
0580	06550	PAVE STRIPING-TEMP REM TAPE-W	2,000.000	LF		
0590	06551	PAVE STRIPING-TEMP REM TAPE-Y	2,000.000	LF		
0600	06568	PAVE MARKING-THERMO STOP BAR-24IN	580.000	LF		
0610	06574	PAVE MARKING-THERMO CURV ARROW	71.000	EACH		

CONTRACT ID: 121328
COUNTY: HARDIN
PROPOSAL: FD04 SSP 047 0251 001-003

PAGE: 4
LETTING: 06/15/12
CALL NO: 305

LINE NO	ITEM	DESCRIPTION	APPROXIMATE QUANTITY	UNIT	UNIT PRICE	AMOUNT
0620	06576	PAVE MARKING--THERMO ONLY	1.000	EACH		
0630	06589	PAVEMENT MARKER TYPE V-MW	379.000	EACH		
0640	06591	PAVEMENT MARKER TYPE V-BY	441.000	EACH		
0650	06598	PAVEMENT MARKING REMOVAL	252.000	SQFT		
0660	10020NS	FUEL ADJUSTMENT	63,439.000	DOLL	1.00	63,439.00
0670	10030NS	ASPHALT ADJUSTMENT	90,760.000	DOLL	1.00	90,760.00
0671	20211ES706	BORE & JACK PIPE (ADDED: 6-11-12)	93.000	LF		
0680	20914ED	ROLLED CURB AND GUTTER	499.000	LF		
0690	23158ES505	DETECTABLE WARNINGS	850.000	SQFT		
0700	23275EN11F	TURF REINFORCEMENT MAT 2	1,538.000	SQYD		
0710	23788EC	TEMP STRAW BALE SILT FENCE	4,447.000	LF		
0720	23789EC	CLEAN TEMP STRAW BALE SILT FENCE	8,894.000	LF		
0730	23790EC	REMOVE AND RECONSTRUCT ISLAND	(1.00)	LS		
0740	23791EC	PAVE STRIPING--CHEVRON MARKINGS	180.000	SQFT		
SECTION 0003 DRAINAGE						
0750	00440	ENTRANCE PIPE-15 IN	78.000	LF		
0760	00468	CULVERT PIPE-36 IN	217.000	LF		
0770	00469	CULVERT PIPE-42 IN	289.000	LF		
0780	00520	STORM SEWER PIPE-12 IN	190.000	LF		
0790	00521	STORM SEWER PIPE-15 IN	6,514.000	LF		
0800	00522	STORM SEWER PIPE-18 IN	4,741.000	LF		

CONTRACT ID: 121328
COUNTY: HARDIN
PROPOSAL: FD04 SSP 047 0251 001-003

PAGE: 5
LETTING: 06/15/12
CALL NO: 305

LINE NO	ITEM	DESCRIPTION	APPROXIMATE QUANTITY	UNIT	UNIT PRICE	AMOUNT
0810	00524	STORM SEWER PIPE-24 IN	1,429.000	LF		
0820	00526	STORM SEWER PIPE-30 IN	971.000	LF		
0830	00528	STORM SEWER PIPE-36 IN	887.000	LF		
0840	00529	STORM SEWER PIPE-42 IN	273.000	LF		
0850	00530	STORM SEWER PIPE-48 IN	776.000	LF		
0860	00554	STORM SEWER PIPE-24 IN EQUIV	317.000	LF		
0870	00556	STORM SEWER PIPE-30 IN EQUIV	272.000	LF		
0880	00559	STORM SEWER PIPE-42 IN EQUIV	235.000	LF		
0890	00560	STORM SEWER PIPE-48 IN EQUIV	50.000	LF		
0900	00981	SLOTTED DRAIN PIPE-15 IN	625.000	LF		
0910	01052	SEWER PIPE-8 IN	119.000	LF		
0920	01434	SLOPED BOX OUTLET TYPE 1-24 IN	2.000	EACH		
0930	01450	S & F BOX INLET-OUTLET-18 IN	2.000	EACH		
0940	01456	CURB BOX INLET TYPE A	111.000	EACH		
0950	01493	DROP BOX INLET TYPE 2	5.000	EACH		
0960	01496	DROP BOX INLET TYPE 3	28.000	EACH		
0970	01499	DROP BOX INLET TYPE 4	1.000	EACH		
0980	01544	DROP BOX INLET TYPE 11	6.000	EACH		
0990	01550	DROP BOX INLET TYPE 12A	113.000	LF		
1000	01559	DROP BOX INLET TYPE 13G	2.000	EACH		
1010	01568	DROP BOX INLET TYPE 13S	8.000	EACH		

CONTRACT ID: 121328
COUNTY: HARDIN
PROPOSAL: FD04 SSP 047 0251 001-003

PAGE: 6
LETTING: 06/15/12
CALL NO: 305

LINE NO	ITEM	DESCRIPTION	APPROXIMATE QUANTITY	UNIT	UNIT PRICE	AMOUNT
1020	01577	DROP BOX INLET TYPE 14	1.000	EACH		
1030	01581	DROP BOX INLET TYPE 16G	1.000	EACH		
1040	01587	DROP BOX INLET TYPE 16S	2.000	EACH		
1050	01650	JUNCTION BOX	3.000	EACH		
1060	01650	JUNCTION BOX B(1)	2.000	EACH		
1070	01650	JUNCTION BOX B(2)	1.000	EACH		
1080	01756	MANHOLE TYPE A	7.000	EACH		
1090	01767	MANHOLE TYPE C	3.000	EACH		
1100	01791	ADJUST MANHOLE FRAME TO GRADE	6.000	EACH		
1110	08100	CONCRETE-CLASS A	40.240	CUYD		
1120	08150	STEEL REINFORCEMENT	2,367.000	LB		
1130	20426EC	SANITARY SEWER CLEANOUT-2 WAY	1.000	EACH		
1140	23131ER701	PIPELINE VIDEO INSPECTION	8,581.000	LF		
1150	23699EC	STEEL ENCASMENT PIPE-30 IN	93.000	LF		
SECTION 0004 SIGNALIZATION						
1160	04793	CONDUIT-1 1/4 IN	700.000	LF		
1170	04795	CONDUIT-2 IN	1,229.000	LF		
1180	04811	ELECTRICAL JUNCTION BOX TYPE B	12.000	EACH		
1190	04820	TRENCHING AND BACKFILLING	1,664.000	LF		
1200	04830	LOOP WIRE	6,398.000	LF		
1210	04844	CABLE-NO. 14/5C	4,035.000	LF		

CONTRACT ID: 121328
COUNTY: HARDIN
PROPOSAL: FD04 SSP 047 0251 001-003

PAGE: 7
LETTING: 06/15/12
CALL NO: 305

LINE NO	ITEM	DESCRIPTION	APPROXIMATE QUANTITY	UNIT	UNIT PRICE	AMOUNT
1220	04850	CABLE-NO. 14/1 PAIR	10,484.000	LF		
1230	04886	MESSENGER-15400 LB	660.000	LF		
1240	04895	LOOP SAW SLOT AND FILL	2,104.000	LF		
1250	04931	INSTALL CONTROLLER TYPE 170	1.000	EACH		
1260	04932	INSTALL STEEL STRAIN POLE	4.000	EACH		
1270	04950	REMOVE SIGNAL EQUIPMENT	2.000	EACH		
1280	20188NS835	INSTALL LED SIGNAL-3 SECTION	12.000	EACH		
1290	20266ES835	INSTALL LED SIGNAL- 4 SECTION	2.000	EACH		
1300	21543EN	BORE AND JACK CONDUIT	191.000	LF		
1310	23064NN	INSTALL SIGNAL-PEDESTRIAN COUNTDOWN	9.000	EACH		
1320	23157EN	TRAFFIC SIGNAL POLE BASE	21.720	CUYD		
1330	23222EC	INSTALL SIGNAL PEDESTAL	4.000	EACH		
1340	23982EC	INSTALL ANTENNA	1.000	EACH		
SECTION 0005 MOBILIZATION / DEMOBILIZATION						
1350	02568	MOBILIZATION (NO MORE THAN 5%)		LUMP		
1360	02569	DEMOBILIZATION (AT LEAST 1.5%)		LUMP		
		TOTAL BID				